

### 3.3 Scale Diagrams

Math 9

#### Scale Diagrams

This scale drawing of a lounge is on centimetre grid paper.

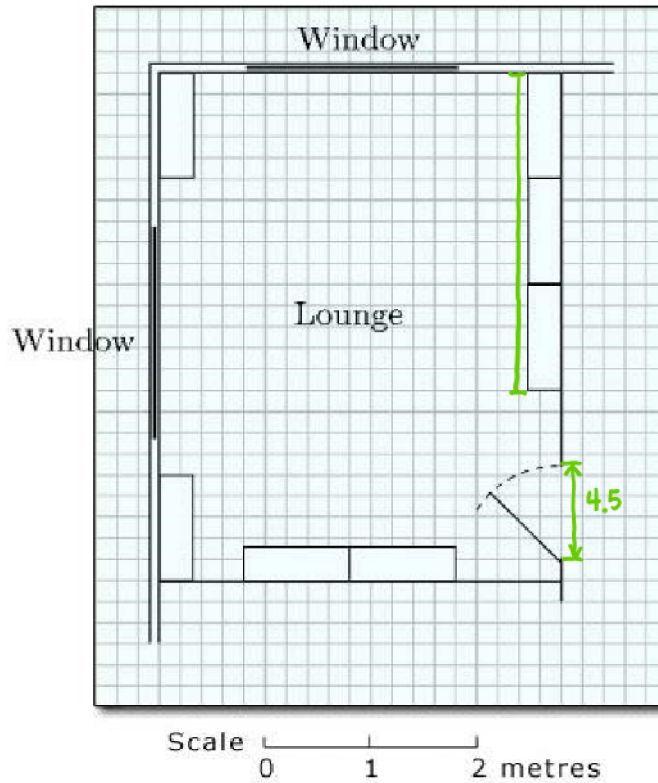

- a) What is the scale of the diagram?  $5\text{cm} : 1\text{m}$   
 $5\text{cm} : 100\text{cm}$   
 $5 : 100$  1 : 20
- b) What are the dimensions of the lounge?  
 $19\text{cm} \times 20 = 380\text{cm}$   
 $24\text{cm} \times 20 = 480\text{cm}$  3.8m by 4.8m
- c) How wide is the door?  
 $4.5\text{cm} \times 20 = 90\text{cm}$  or 0.9m
- d) How wide are the windows?  
 $10\text{cm} \times 20 = 200\text{cm}$  2m
- e) How wide is the shelving unit along the right wall?  
 $15\text{cm} \times 20 = 300\text{cm}$  3m
- f) How wide is the shelving unit along the bottom wall?  
 $10\text{cm} \times 20 = 200\text{cm}$  2m

To avoid clutter, many scale drawings include a minimum amount of information. Use the measurements given to determine the missing dimensions.

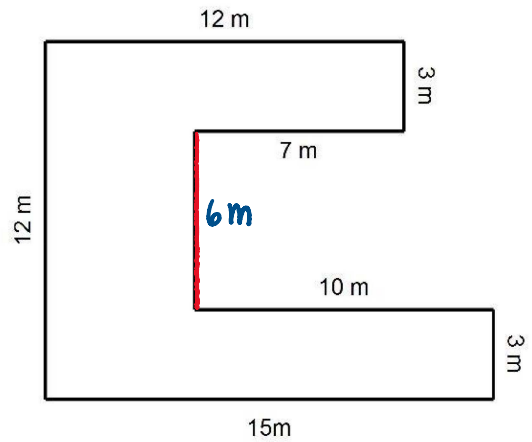
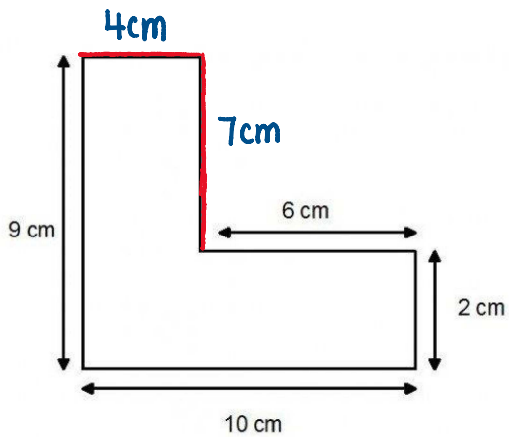
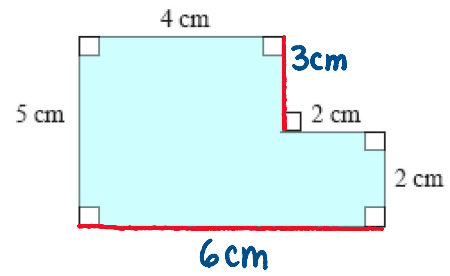
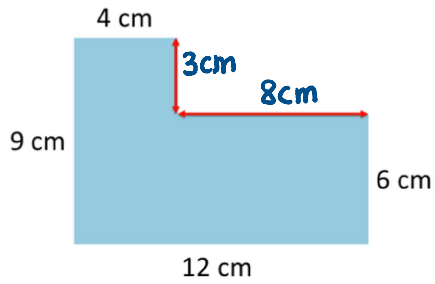

#1,2,4,7-9

Assignment: ~~#1,2,4,7,8,9~~ (handout)